



**INSTALLING YOUR
PLATINUM
6000
QUICK FIX
CAVITY UNIT**

INSTALLING YOUR PLATINUM 6000 CAVITY UNIT

Thank you for purchasing the Platinum 6000 Heavy Duty Cavity Door Unit.

Please follow these instructions carefully. Proper installation and maintenance will bring you years of trouble-free use.

IMPORTANT INFORMATION:

Single cavity units have a door weight limit of 125kg. Double cavity units have a door weight limit of 85kg each door. Cavity units are not load bearing. When installing double cavity units it is important that the track is fixed to a structural member. Screw through the centre of track using the holes provided. Only use button head screws (not provided in fittings). Note: Do not pack between the top of the track and the structural timber.

Care should be taken when installing the cavity unit into wall tiled areas. Please consult with the substrate/tile manufacturer as to their recommended fixing and tiling methods in accordance with the relevant standards.

Do not remove the temporary spacer blocks in the opening of the cavity throat until the wall sheeting has been completed.

CONTENTS:

Check that you have all the contents and tools to install your Platinum 6000 Heavy Duty Cavity Door Unit.

Contents include:

- 1 x cavity pocket
- 1 x head track assembly
- 2 x removable fillets
- 1 x glide guide kit*
- 1 x trolley kit
- 1 x closing jamb†
- 1 x 60mm converter bumper stop
- 2 x 10mm bumper stops

Glide guide kit includes*:

- 2 x glide guide strips
- 2 x nylon finger guides
- 2 x 15mm round head screws

Trolley kit includes:

- 2 x carriage assemblies
- 2 x door support brackets
- 1 x reversible door guide*
- 1 x spanner
- 2 x 25mm needle point screws
- 2 x 16mm pan head screws
- 1 x 15mm countersunk screw
- 4 x 35mm countersunk screws
- 4 x 30mm hex head screws
- 1 x 25mm concrete nail
- 4 x complete snap caps
- 10 x 16mm button head metal thread screws
- 3 x 65mm metal thread hex head screw

† VIC, SA, WA only. * WA, NSW, QLD only.

Platinum 6000 Cavity Elevation

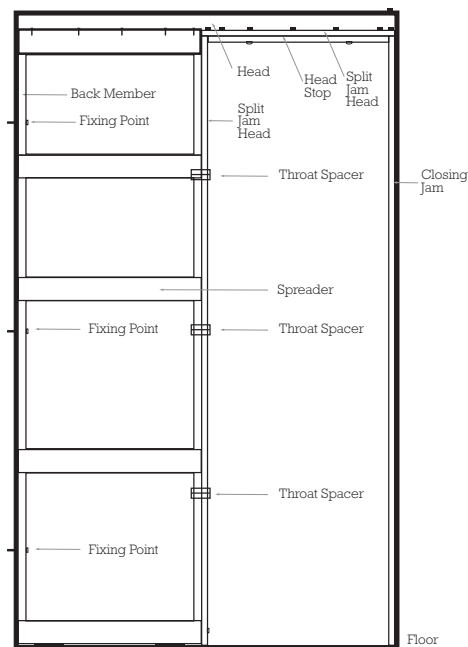

Cavity unit with door in fully open position

Flush Jamb

10mm Flush Jamb Bumper

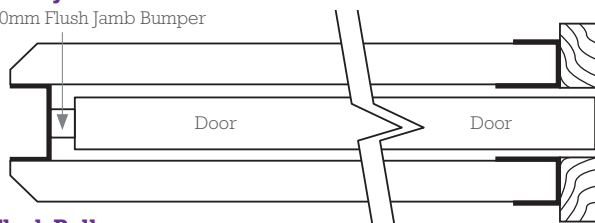

Flush Pull

60mm Converter Bumper

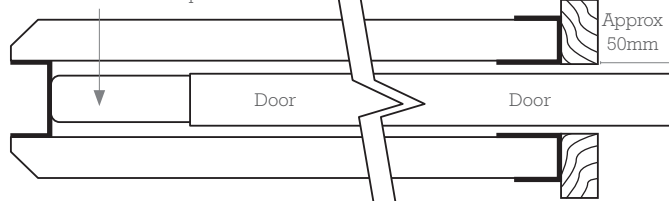

Please note: For a flush jamb fitment, install the 2 x 10mm converter bumper stops onto the edge of the door, closest to the cavity pocket. To convert a flush jamb cavity into a flush pull unit, install the 60mm converter bumper stop onto the edge of the door, closest to the cavity pocket and central to the height of the door. Ensure the position of the bumpers are not in line with the backpost fixing screws. Some unit sizes/types may not be available in all states.

STEP 1

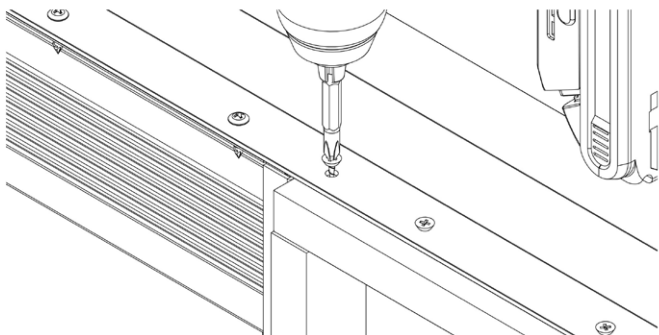

Fit and screw the head track assembly to the cavity pocket using the 10 x 16mm button head metal thread screws. **Do not remove the temporary spacer blocks in the opening of the cavity throat until the wall sheeting has been completed.**

STEP 2 Using 50mm screws (not provided in fittings), secure the split jamb head to the split jamb stile (ensure this is predrilled prior to screwing). Turn the cavity pocket over and repeat Step 2.

STEP 3

VIC, SA, WA only

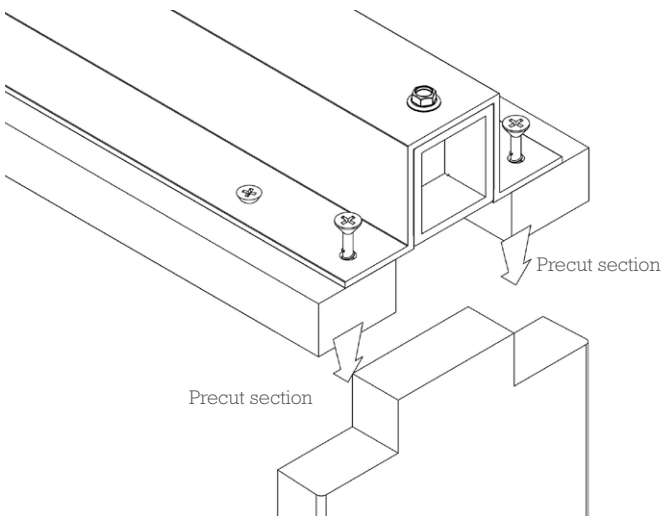

Cut down the sides from the end of the closing jamb – refer to the pre cut section in the detail shown. Screw (not provided with fittings) the closing jamb to the head section fixing through the head timber into the closing jamb stile.

Note: If a double door unit is being installed a closing jamb is not supplied. Insert the two door stops at the centre of the track.

STEP 4 Place the assembled unit in position in the opening. Ensure the unit is level, plumb and straight. Fasten through the back post by packing and securing into the stud/brick using the supplied 3 x 65mm metal thread hex head screws. The positioning of the fixing screws should be 250mm from top, bottom, and centre of the height of the back post. A minimum of three fixings is required. **Do not remove the temporary spacer blocks in the opening of the cavity throat until the wall sheeting has been completed.** Fasten the base to the floor using the 1x concrete nail provided or alternative fixing method.

STEP 5

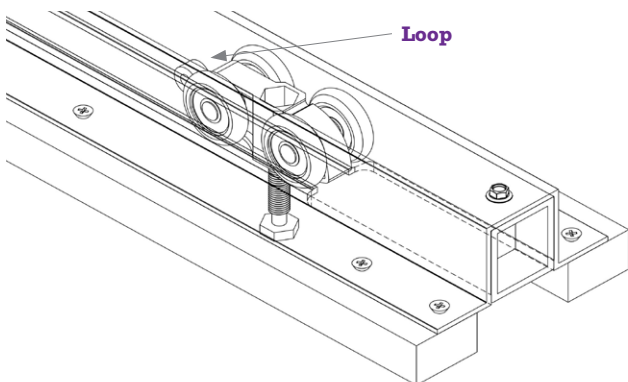

Place 2 x carriage assemblies in the track.
Ensure side of roller with "Loop", is inserted first.

STEP 6

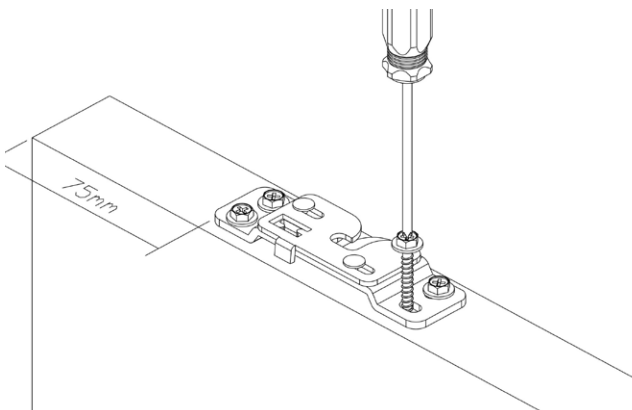

Attach the 2 x door plates to the top of the door using the 8 x 30mm hex head screws. The door plates are fixed 75mm in from each side and central to the thickness of the door. **Ensure both door plates are facing in the same direction**

STEP 7

QLD, NSW, WA only

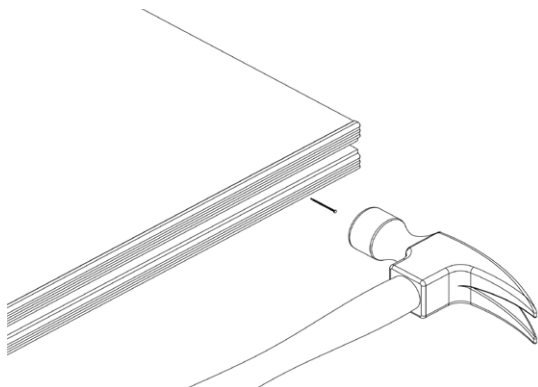

Cut the 2 x glide guide strips to suit the door width. Tack both strips to the bottom of the door using 5 x panel pins with each glide guide strip. (Total 10 x panel pins).

STEP 8

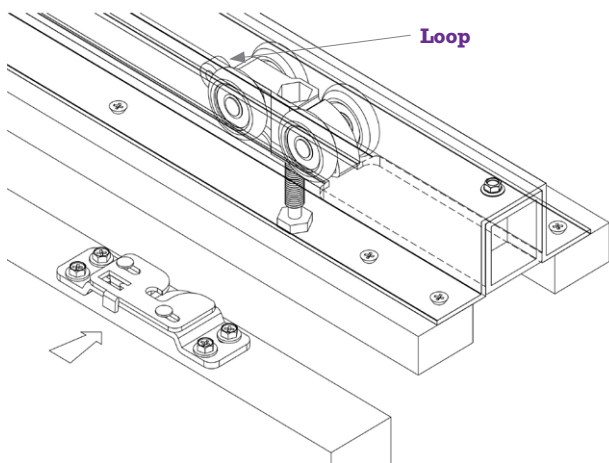

With the door in the cavity opening, lift the door to locate each door plate onto the carriage assembly bolt.

STEP 9 Use the spanner provided to raise and level the door to the required height and to plumb against the closing jamb.

STEP 10 Slide the reversible door guide along the groove in the bottom of the door. Loosely screw the guide to the split jamb using the 2 x 16mm pan head screws. Centre the door in the pocket and then fully tighten screws..

Note: SA, VIC only. Refer diagram 11B.

STEP 11

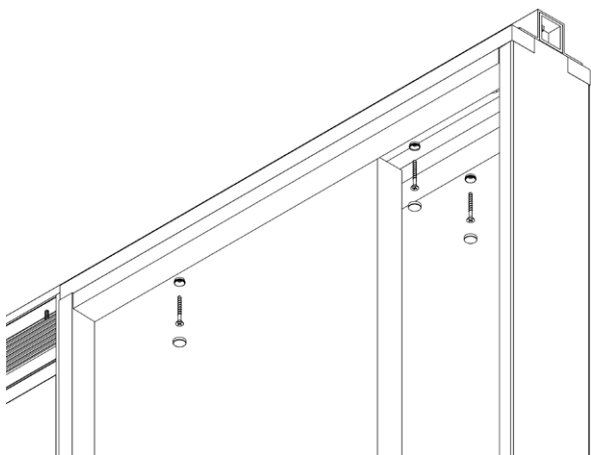

Screw in place the removable fillets using 4 x 35mm countersunk screws through a white snap cap base. Finish off with supplied snap caps. Refer to drawing in step 11 and diagram 11A or 11B depending on your state.

DIAGRAM 11A

QLD, NSW, WA only

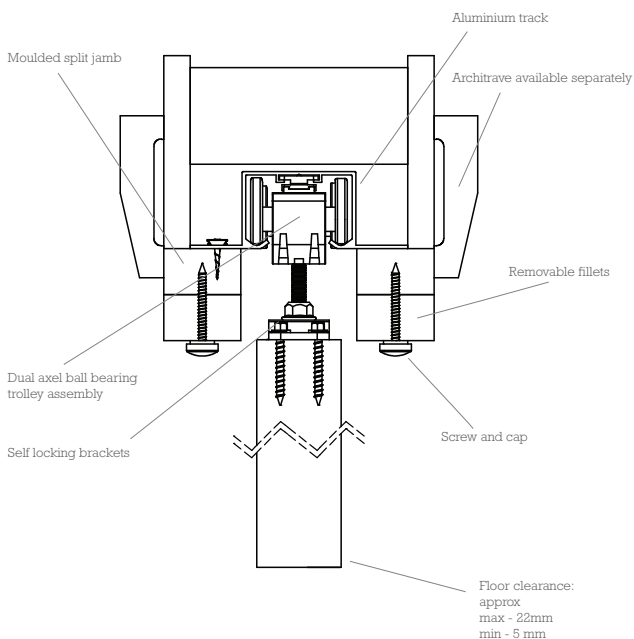
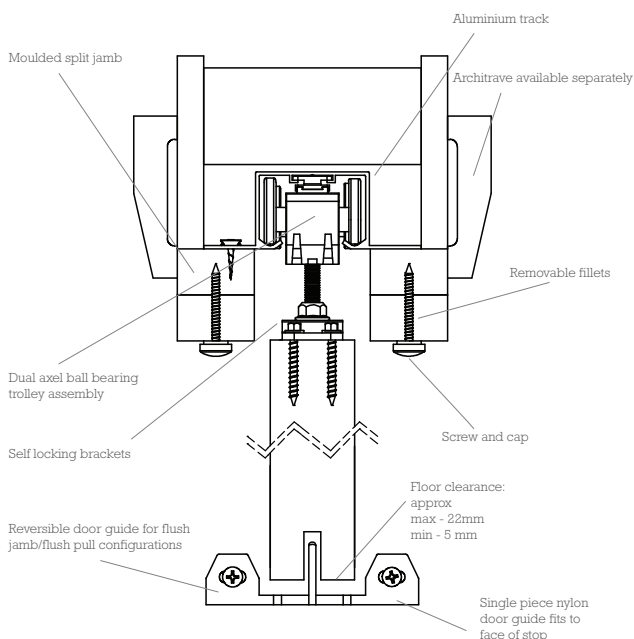

DIAGRAM 11B

SA, VIC only



STEP 12

QLD, NSW, WA only

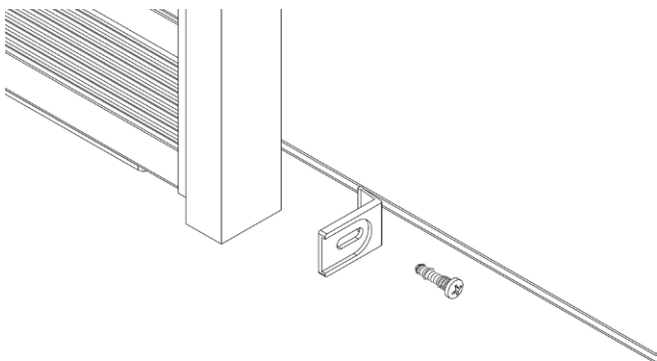

Fix the two nylon finger guides to the base of the frame using the elongated opening (for subsequent adjustment). The flexible portion protrudes into the cavity. When the guides are positioned correctly, fasten with 2 x 15mm round head screws.

CONTACT

For further information Contact your Corinthian Door Reseller or Corinthian direct:

Sydney (02) 9673 7111

Melbourne (03) 9794 1122

Brisbane (07) 3715 0100

Adelaide (08) 8243 0888

Perth (08) 9455 1333

www.corinthian.com.au



www.corinthian.com.au

Whilst the utmost care is taken to ensure the accuracy of the information contained herein, it is provided in the understanding that the company shall under no circumstances be liable for any injuries, expenses or other losses which may in any way be attributable to the use or adoption of such data and/or design details. All dimensions indicated are nominal only. Corinthian Doors reserves the right to alter or amend without prior notice data and design details specified herein. Photographs or illustrations may not exactly depict the design or specification and may vary to actual. Re-Order Code JWCNAT0604/0923. JELD0910